

FEB. 2, 2011 NOTES/QUESTIONS:  
 DO WE NEED TO SHOW ALL JUNCTION BOXES ON PLAN?  
 DO WE NEED TO PUT CIRCUIT NO.'S ON PLAN?  
 RECEPTACLES ARE INSTALLED IN FOLLOWING CONDITION:  
 NO NOTES: WIRES RUN TO BOX ON FLOOR/WALL  
 NO NOTES (EXTERIOR): WIRES RUN, BOX NOT INSTALLED  
 COMPLETED: INSTALLED AND IN USE

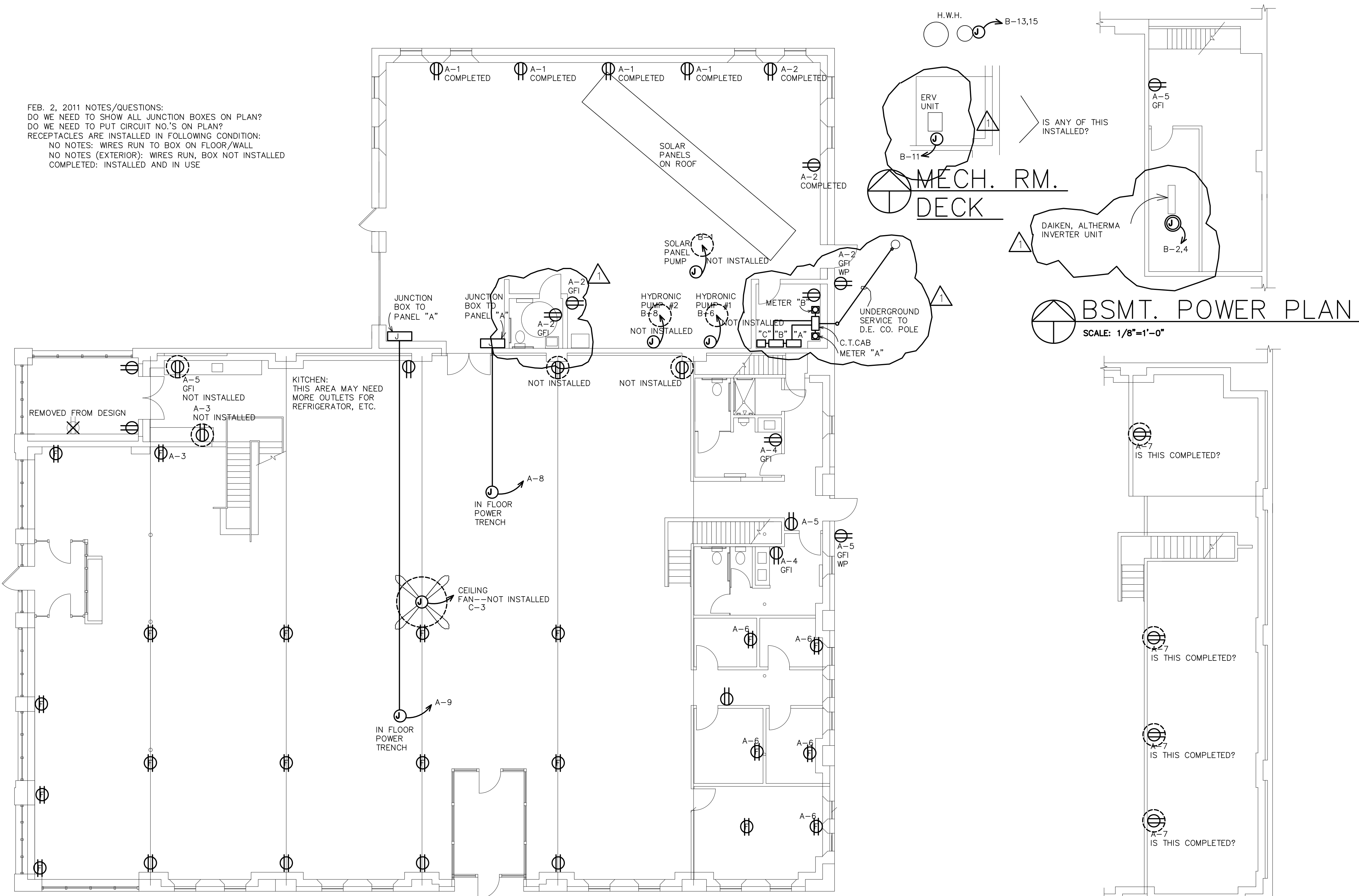

- ELECTRICAL NOTES:**
1. All work shall be in accordance with the National Electric Code (N.E.C.), latest edition, and all Local and State Codes and Regulations.
  2. All other new wiring shall be cooper types THW, THWN, or XHHW. Minimum size shall be #12.
  3. Provided grounding for all new receptacles. Provide Ground Fault Interrupter Circuits with reset, in all wet areas.
  4. All electrical work shall be performed by a Licensed Electrical Contractor who will be responsible for all permits and inspections related to the electrical work.
  5. Electrical wiring and equipment shall be manufactured by: Triangle, Youngstown, General Electric, Hartfield, or equal.
  6. Provide a complete, typed, panel schedule in each electric panel, relating to the area of work, designating the location of each circuit.
  7. All lighting fixtures are to be selected by Owner and supplied and installed by Electrical Contractor.
  8. Wire all new circuits into New Electric Panels.
  9. All existing outlets, not shown on plans, are to remain as is.

**LEGEND**

- ⌚ SINGLE POLE SWITCH, 48" AFF
- ⌚ NEW DUPLEX RECEPTACLE OUTLET
- ⌚ NEW IN FLOOR DUPLEX RECEPTACLE OUTLET
- GFI GROUND FAULT INTERRUPTER
- WP EXTERIOR GRADE RECEPTACLE BOX
- ⊕ 208 V JUNCTION BOX
- ⊕ 120V JUNCTION BOX
- ▼ NEW DATA/PHONE BOX
- ⊗ NEW L.E.D. EXIT LIGHT WITH BATTERY BACKUP WIRED TO LOCAL CIRCUIT
- ⊗ NEW L.E.D. EXIT LIGHT & EMERGENCY LIGHT WIRED TO LOCAL CIRCUIT
- ⊗ NEW L.E.D. EMERGENCY LIGHT WIRED TO LOCAL CIRCUIT
- ⊗ EXISTING FIXTURE WITH NEW HIGH EFFICIENCY BULB

**ELECTRICAL POWER PLAN**  
 SCALE: 1/8"=1'-0"

**MEZZ. POWER PLAN**  
 SCALE: 1/8"=1'-0"

GREEN GARAGE AS BUILT  
 02-02-11 AS BUILT/IN PROGRESS

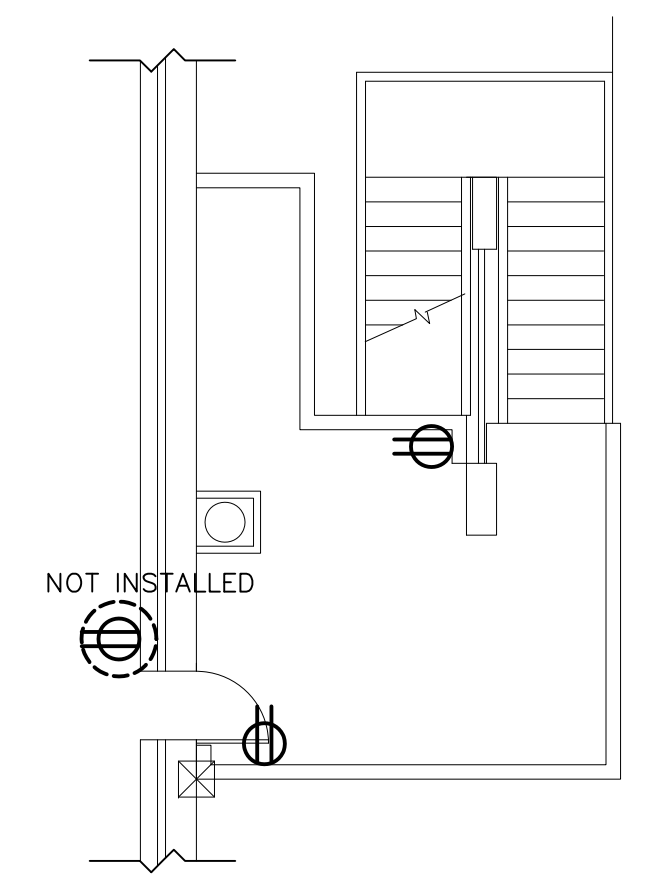

**FRONT MEZZ. POWER PLAN**  
 SCALE: 1/8"=1'-0"

REV.	DATE	ISSUE FOR	REVISIONS
5-27-10		REV. PER OWNER	
8-17-09		FOR PERMIT	
8-3-09		REVISED	
7-30-09		OWNER REVIEW	

GREEN GARAGE RENOVATION  
 4444 SECOND AVENUE  
 DETROIT, MI 48201

Architects Planners Engineers  
**ARCHITECTS INTERNATIONAL, INC.**  
 17400 Wildemere  
 Detroit, Michigan 48221  
 Phone: 313-341-7930  
 Fax: 313-341-6944

DESIGNED	TLB	CHECKED	TLB	PROJECT NO.
DRAWN	TLB	DATE	6-1-09	0923
APPROVED	TLB	DATE	6-1-09	
SHEET TITLE	ELEC. POWER PLAN			SHEET NO. E-1